

INSTALLATION MANUAL TRILIFT:

INSTALLATION AND OPERATION INSTRUCTIONS -SERVICE AND PARTS INFORMATION

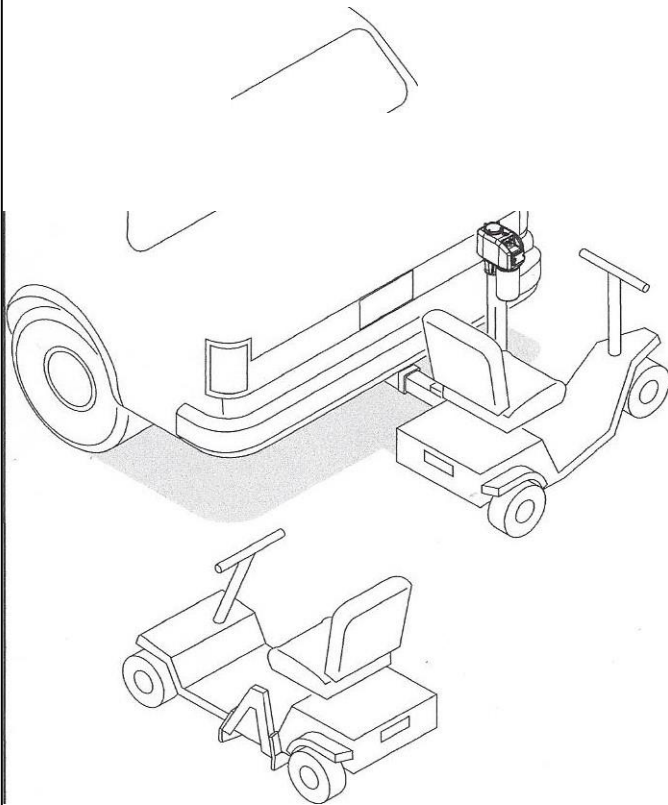

IMPORTANT

A receiver hitch must be installed by a reputable hitch installer. Hitch must be level side to side and fore to aft. Distance from top of receiver to ground should be no less than 12" and no more than 22"

Vehicle must be in good repair. Worn or damaged vehicle parts must be repaired or replaced before the hitch is installed.

CONTENTS OF CARTON:

PART#	QTY.	DESCRIPTION
TI 010 /2		ACTUATOR 24"
L		"L" ADAPTOR OR
TA	1	TILT ADAPTOR
PH	1	POWERHEAD
SB	1	SCOOTER'S DOCKING DEVICE OR
PWC		POWER WHEELCHAIR DOCKING DEVICE
SHP		SILENT HITCH PIN

TOOLS NEEDED:

1. HEX BIT 5/32"; 3/8";
2. SCREW DRIVERS (PHILLIPS AND FLAT HEAD)
3. 7/16"; 1/4"; 3/8"; 1/2", 5/8", AND 3/4" SOCKETS OR WRENCHES

A Warning

READ AND UNDERSTAND INSTALLATION INSTRUCTIONS VEHICLE MUST BE IN SAFE PARKED CONDITION
IGNITION SWITCH MUST BE IN "LOCK" POSITION
REMOVE JEWELRY (WATCHES, RINGS, ETC.)



TRILIFT
1518 S. Santa Fe Ave.
Compton, CA 90221
H00-300-4192 (U.S.)

PAGE: 1 OF 12	DATE: 1 FEB08	FORM#: 20803
REVISION: E	ECN#: 13644	APPROVED:

INSTALLATION MANUAL TRILIFT:

A Warning

If maximum weight is exceeded, the design modified, or the unit is installed in a way contrary to manufacturer's instructions the warranty is void and catastrophic failure may occur. This could result in serious injury or death.

INSTALLATION INSTRUCTIONS:

1. FASTEN LIFT ASSEMBLY TO CLASS III RECEIVER HITCH (CUSTOMER SUPPLIED)

SLIDE 'L' ADAPTOR INTO HITCH. FASTEN ASSEMBLY TO HITCH WITH BOLT (20), LOCKWASHER (22), AND HEX NUT (21), TIGHTEN ALL FASTENERS. INSTALL COTTER PIN OR LOCK (23)- DO NOT OVERTIGHTEN

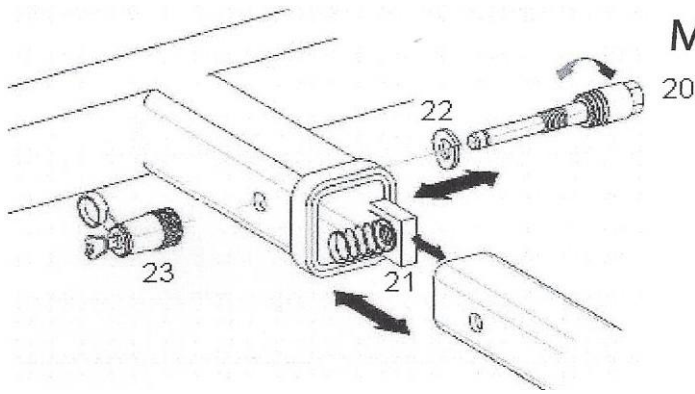

MAXIMUM LOAD WEIGHT: 450 LBS.

1B. FASTEN LIFT ASSEMBLY TO CLASS-I OR II RECEIVER HITCH (CUSTOMER SUPPLIED)

INSTALL HEX NUT (28), INTO THE SOLID BAR ON THE T' ADAPTOR AND SLIDE T' ADAPTOR INTO HITCH. FASTEN ASSEMBLY TO HITCH (26), LOCKWASHER (27), AND TIGHTEN ALL FASTENERS. INSTALL COTTER PIN OR LOCK (29)- DO NOT OVERTIGHTEN

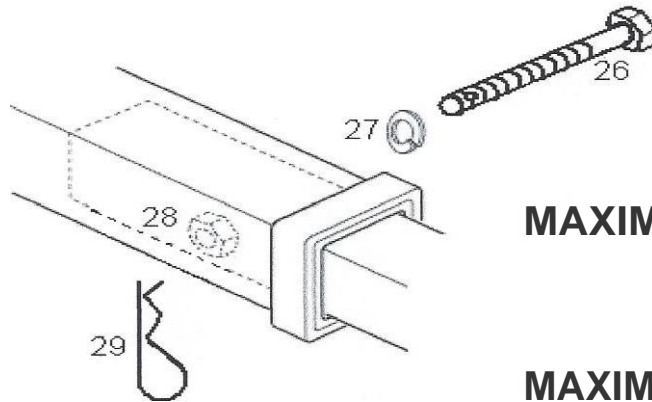

CLASS-I HITCH

MAXIMUM LOAD WEIGHT: 120 LBS.

CLASS-II HITCH

MAXIMUM LOAD WEIGHT: 180 LBS.



TRILIFT
1518 S. Santa Fe Ave.
Compton, CA 90221
1-800-300-4192 (U.S.)

PAGE, 2 OF 12	DATE, 1 FEB 08	FORM#, 20803
REVISION LETTER, E	t<.Nfc 13036	APPROVED,

INSTALLATION MANUAL TRILIFT:

3. FASTEN ACTUATOR TO "L" ADAPTOR

2 Slide actuator onto "L:" adaptor
do not install the any bolts.

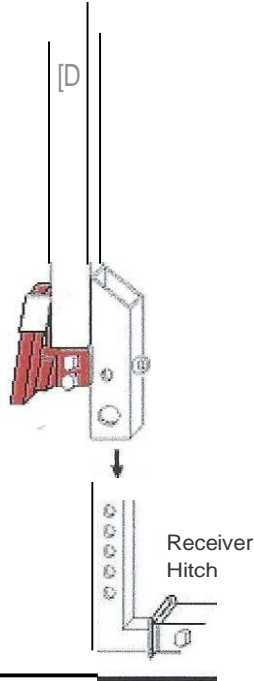

3 Slide powerhead onto actuator
and tighten bolts (17)

DONOT OVERTIGHTEN.

Connect power to powerhead.

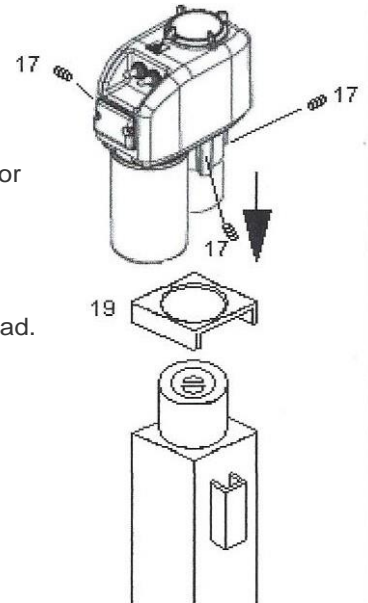

4B TRILIFT ULTRA LITE

Turn power on and
lower the lift downwards,
so that the lift extends all the way out
(for maximum ground clearance)
install and tighten bolts.

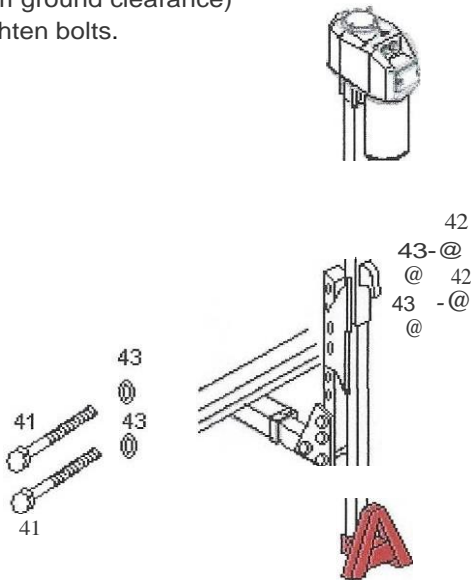

4 TRILIFT Turn power on and lower the lift downwards,

so that the lift extends all the way out

(for maximum ground clearance)

install bolt (31) and locknut (33)

the bolt (32) round head goes through the larger opening
(no washer)

Install bolt (34) with (37) nut.this bolt isto adjust the
angle of the lift isnotmast to be tit.

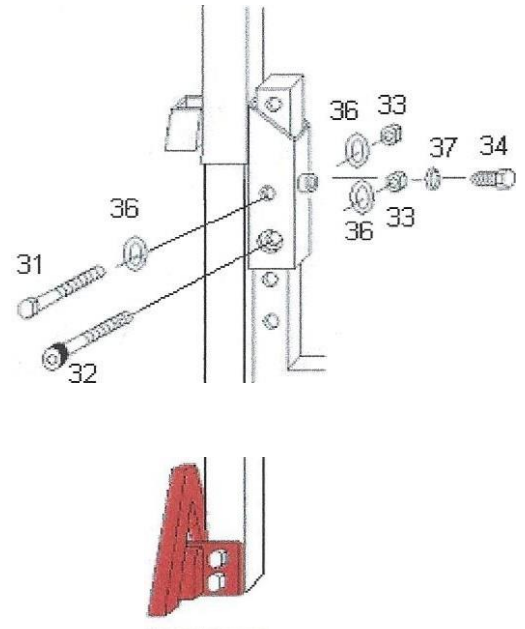

TRILIFT
1518 S. Santa Fe Ave.
Compton, CA 90221
1-800-300-4192 (U.S.)

PAGE: 3 OF 12	DATE: 1 FEB08	FORM#: 20803
REVISION LETTER: E	ECN#: 13036	APPROVED:

INSTALLATION MANUAL TRILIFT:

POWERHEAD WIRING:

Use crimp or solder connections

Connect battery's positive terminal to circuit breaker (40 amp) with 10gauge wire or larger.

Connect circuit breaker to powerhead with 10gauge wire or larger and butt splice.

when using oem wiring
make sure a 40 amp fuse is
installed in the fusebox

A Warning

Do not change wiring order
in the 7-pin plugs

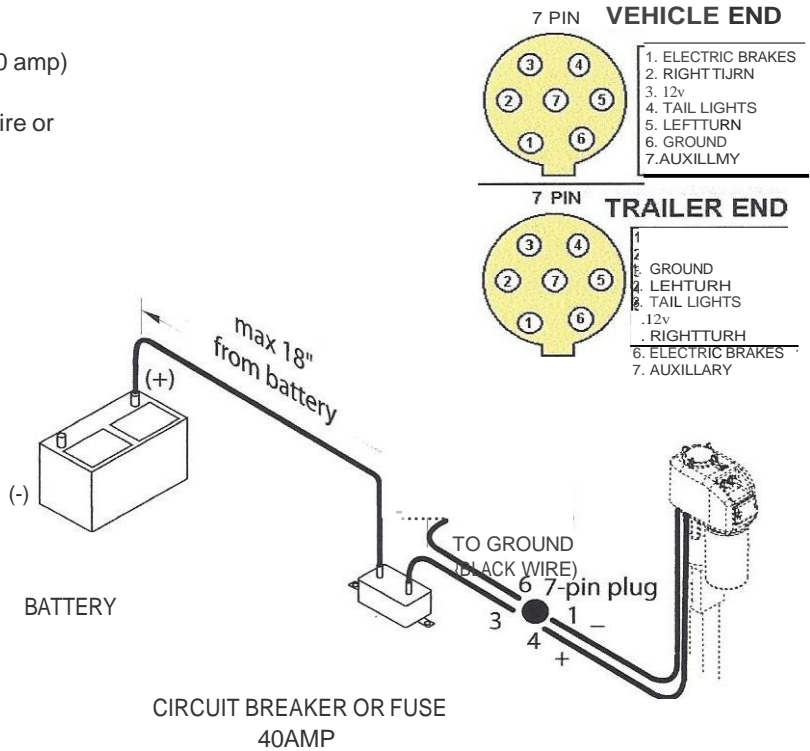

5. INSTALL SCOOTER BRACKET:

(separate instruction)

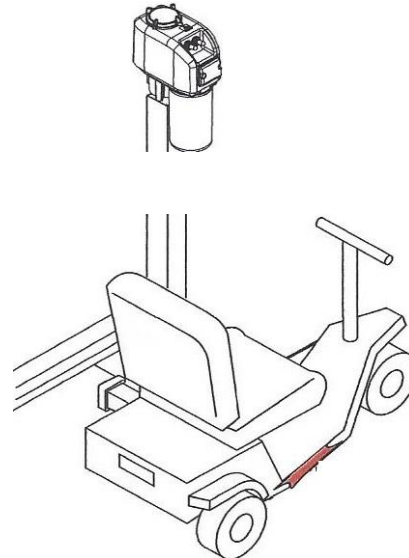

REFLECTOR STICKER

6. INSTALL REFLECTOR STICKER

Reflector should be installed on the right side of the scooter so it is visible from the rear while scooter is loaded on the lift.



TRILIFT
1518 S. Santa Fe Ave.
Compton, CA 90221
1-800-300-4192 (U.S.)

PAGE, 4OF 12	DATE, 1 FEB 08	FORM#, 20803
REVISION, H	iC: N#, 13644	APPROVED,

INSTALLATION MANUAL TRILIFT:

OPERATING INSTRUCTIONS:

The added length and weight of the Trilift, and a scooter or wheel chair, will effect how your vehicle handles. It will be more sensitive on slippery roads or in a cross wind.

Adjust your driving style to match conditions. Drive slowly until you become familiar with how the vehicle handles when turning and backing up. Plan for turns, stops, and lane changes well in advance. Avoid slippery conditions, (i.e.-ice, snow, and loose gravel). Reduce speed on rough surfaces or going up and down slopes, (i.e.- driveways). Remember added overall length when backing up, parking, etc.

Operators must become familiar with all controls and procedures. Understand what the Trilift can do and its limits. Practice using it safely.

These safety labels are on the Trilift. Know where they are; read, understand, and obey them.

AWARNING

Avoid serious injury, or death, to yourself and others. Follow these instructions:

- Read and understand OPERATOR'S INSTRUCTIONS before using TRILIFT.
- Transporting vehicle must be safely parked, on a flat level surface, when loading and unloading scooter.
- Keep body, hands, and feet away from shearing/ squeezing points.
- When transporting, scooter must be secured to liftlocking system
- When scooter is not on lift, Triangle must be secured all the way up in the hold bracket.
- **NO RIDERS** on lift.
- Do not overload lift
Maximum capacity 400 lbs.

19991-A

INSPECTION:

Before using the Trilift, the user must inspect it completely to insure safe operation:

- * Actuator, triangle, and docking device on the scooter, Look at their condition, check for: cracked or broken parts, loose or missing fasteners
- * Rocker Switch- Must work freely and return to neutral when released.
- * Tires (transport Vehicle)- Tires must be in good condition. Check tire pressure, Tires must be inflated to recommended pressure.
- * Safety Labels-If safety labels are missing or unreadable, replace them immediately.
- * If the unit is unsafe or in need of repair, do not use it until it is returned to a safe operating condition.

!!!IMPORTANT NOTICE!!!

DO NOT install the Trilift on the rear of "towed" vehicles. This includes travel trailers, 5th Wheels, etc. The excessive shock loading that occurs in this location is not compatible with the Trilift design. The Trilift warranty is void when a unit is installed in this manner

AWARNING

Don't risk serious injury or death in a shearing or squeezing accident. Keep

body, hands, and feet away.



A WARNING MAXIMUM WEIGHT: 400 LBS

If maximum weight is exceeded, the design modified, or the unit is installed in a way contrary to manufacturer's instructions the warranty is void and catastrophic failure may occur. This could result in serious injury or death.

29234



TRILIFT
1518 S. Santa Fe Ave.
Compton, CA 90221
1-800-300-4192 (U.S.)

PAGE: 5 OF 12	DATE: 1 FEB 08	FORM#: 20803
REVISION LETTER: E	ICN#: 13036	APPROVED:

INSTALLATION MANUALTRILIFT:

OPERATING POSITION:

VEHICLE must be in a safely parked position on a flat level surface. Allow enough room to safely load and unload scooter or wheel chair.

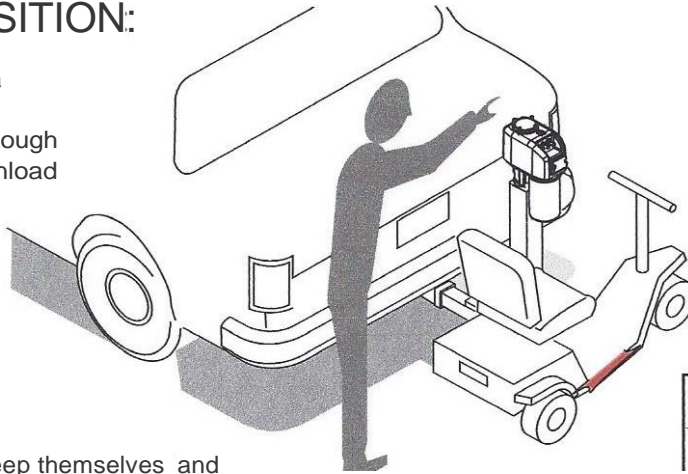

OPERATOR must keep themselves and others away from moving parts.

AWARNING

Don't risk serious injury or death in a shearing or squeezing accident. Keep body, hands, and feet away.



OPERATION (ELECTRICAL)

When the powerhead reaches the end of its travel (either raising or lowering), a built in torque limiter goes into operation with a clicking noise.

This torque limiter permits the final drive gear to slip; thus protecting the unit

PROLONGED OPERATION OF THE TORQUE LIMITER IS NOT RECOMMENDED.

The "night-light" is controlled by this toggle switch

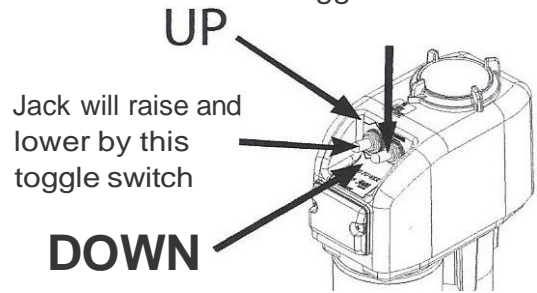

OPERATION (MANUAL)

If an electrical failure should occur, the emergency handle may be inserted into the actuator post and the actuator can be raised and lowered.

WHEN CRANK HANDLE IS BEING USED, DO NOT PUSH ROCKER SWITCH

If powerhead is removed, crank can still be used to raise and lower actuator



TRILIFT
1518 S. Santa Fe Ave.
Compton, CA 90221
1-800-300-4192 (U.S.)

PAGE, 6 OF 12	DATE, 1 FEB 08	FORM#, 20803
REVISION LETTER, H	ECN#, 13507	APPROVED,

FOLD UNIT DOWN for access to rear of vehicle, trucks, van cargo doors, etc.

IMPORTANT: Scooter or chair must be removed from lift.

TO FOLD DOWN

- Hold unit up.
- Push on the (
- Remove quick
- Pivot unit do

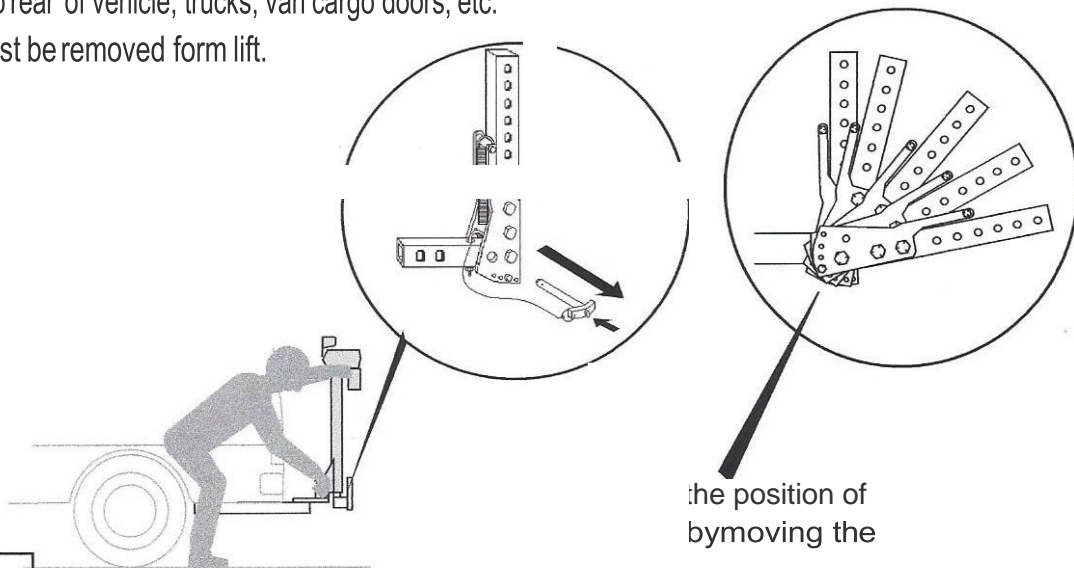

AWARNING

Don't risk seriOlsinjury or death in a shearing or squeezingaccident. Keep



TO FOLD UP

- Pivot unit allthe way up and hold
- Push on the quick release Button.
- Put quick release pin.

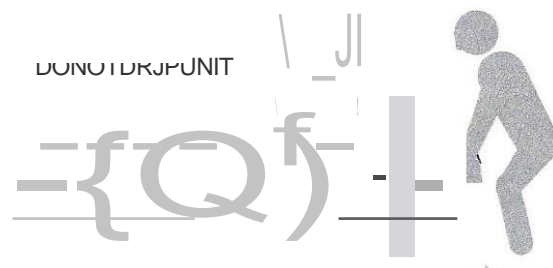

MAINTINANCE



MAINTB\ANCE:

Avot pointsshould begreased, asneeded, with lithium based grease.

Once a year, the powerhead should be removed and a liberal amount of grease (preferably a grease with high melting point) applied directly to the coupling on which the drive pin rests. DONOT POUROILinto top of the jack post.

Once a year, the housing cover should be removed and the gears inspected for proper lubrication. !=€move 4 :::IXeNS and tap around edge of housing to freecover.DO NOT inert s:::re-N driver blade! (Thismay damage mating surfaces.) Before replacing cover, clean mating surfaces. If lubrication is needed, ure Lubriplate ffi-132 grease or equivalent.



TRILIFT
1518 S. Santa Fe Ave.
Compton, CA 90221
1-800-300-4192 (U.S.)

PAGE: 7 OF 12	DATE: 1 FEB 08	FORM#: 20803
REVISION/LITTER: H	ECN#: 13644	APPROVED:

OPERATING INSTRUCTIONS

For loading a scooter

1. Insert the key into key switch, and turn to ON position.
 2. Push switch to down position, so the lift extends all the way down to the ground or to the end.
 3. Drive the scooter so the docking bracket will be at the same line, and 3" from the lift male triangle pic - 1
 4. Turn the scooter steering slightly to the right pic- 1 drive forward and turn scooter steering back to the left pic-2 and pic-3 so the bracket will be above the red triangle pic-4.
 5. Push switch to up position so the lift grabs the scooter bracket and the scootera_II the way up
- IMPORTANT:**
6. Check if the docking bracket locks in position pic -5
 7. Switch the key off and remove it.

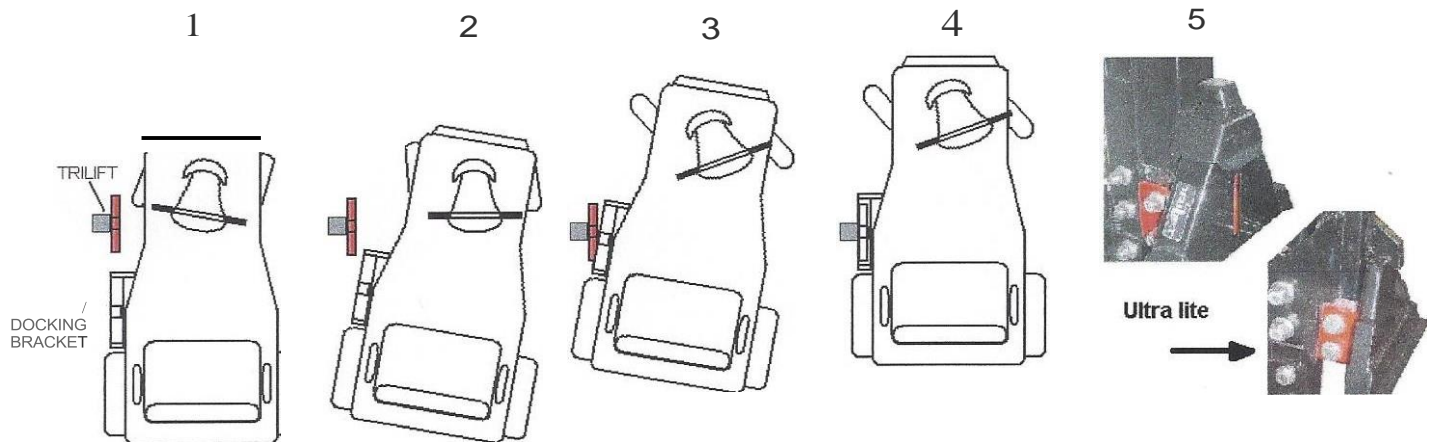

For unloading a scooter

1. Insert the key into key switch and turn to ON position.
2. Push switch to down position, so the lift extend all the way down to the ground or to the end.
3. Drive the scooter forward, turn the wheels all the way to the left and drive the scooter backward and away.
4. Push switch to up position to lock lift all the way up.
5. Switch the key OFF and remove it.



TRILIFT
1518 S. Santa Fe Ave.
Compton, CA 90221
1-800-300-4192 (U.S.)

PAGE: 8 OF 12	DATE: 1 FEB 08	FORM#: 20803
VISION LETTER: H	ECN#: 13644	APPROVED:

For loading power wheelchairs

1. Insert the key into key switch and turn to ON position.
2. Push switch to down position all the way down to the ground or to the end
3. Drive the wheelchair backward so the docking bracket will be above the red triangle
4. Push switch to up position so lift grab the power wheel chair bracket all the way up
- IMPORTANT:** 5. Check that the docking bracket is locked in position pie -5
6. switch the key OFF and remove it.

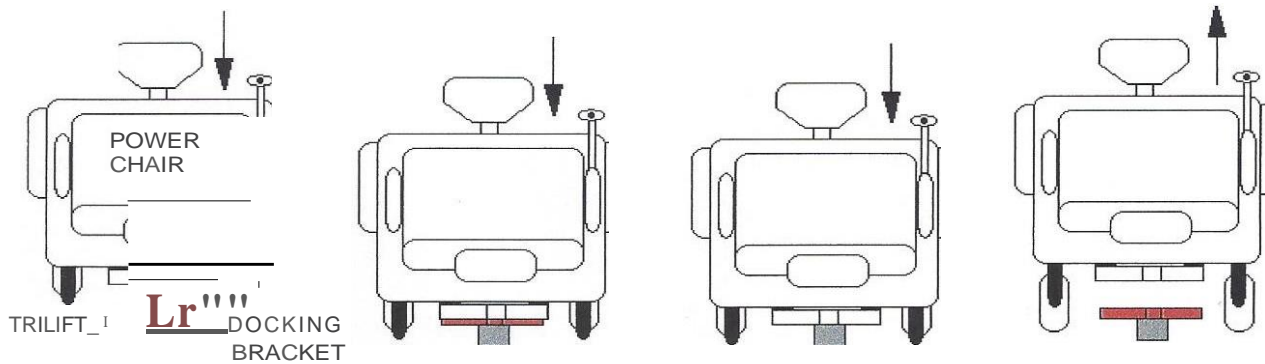

For unloading wheelchairs

1. Insert the key into key switch and turn to ON position.
2. Push switch to down position all the way down to the ground or to the end.
3. Drive the wheelchair forward a way from the lift. Push switch to up position all the way.
4. Push switch to up position to lock lift all the way up.
5. Switch the key OFF and remove it.



TRILIFT
1518 S. Santa Fe Ave.
Compton, CA 90221
1-800-30Q-4192 (U.S.)

PAGE: 90F 12	DATE: 1 FEB08	FORM#: 20803
REVISION LITTER: H	ECN#: 13644	APPROVED:

OWNER'S MANUAL TRILIFT

TRILIFT PARTS:

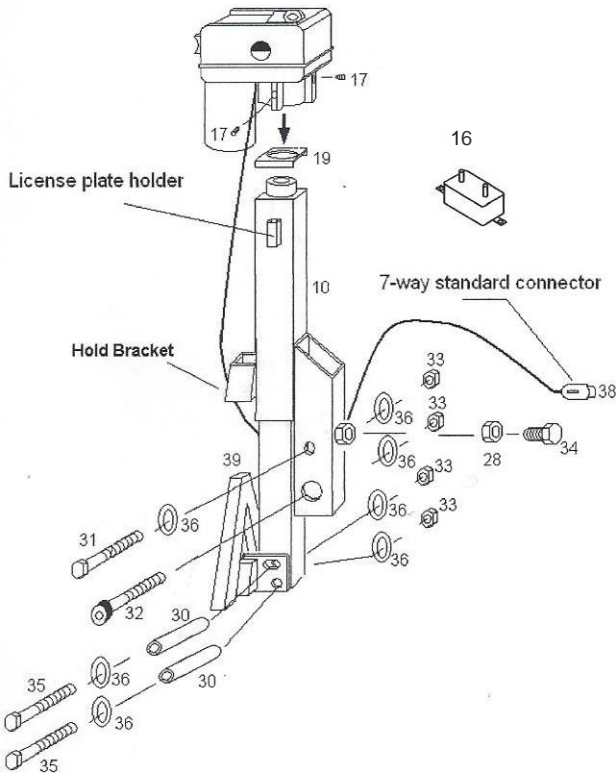

TRILIFT ULTRALITE PARTS:

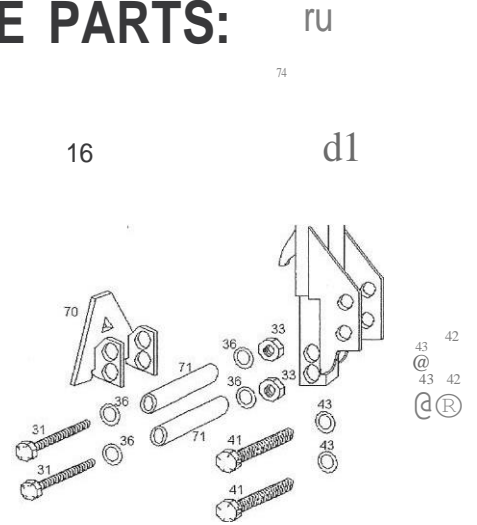

TA PARTS:

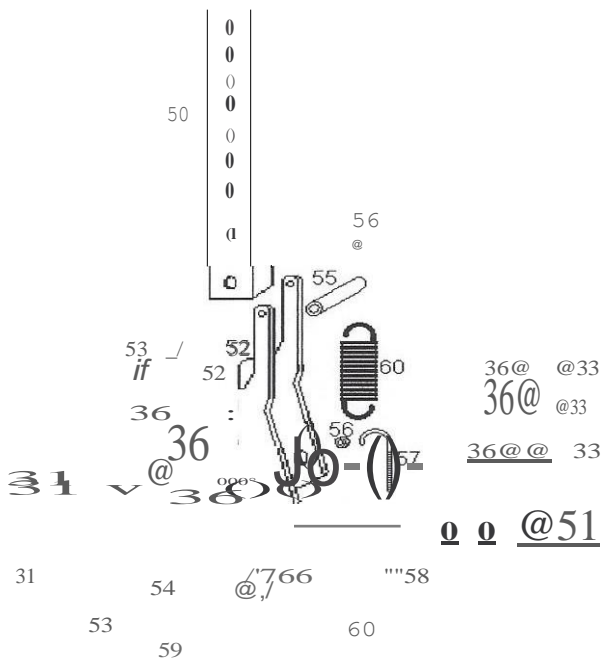

"L" ADAPTOR - CLASS 1-11

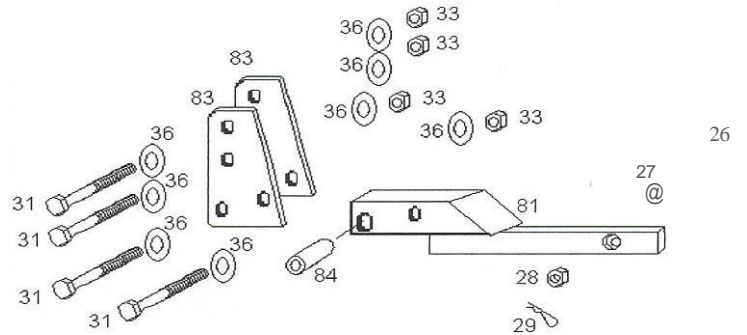

TA-HD-EXT PARTS:

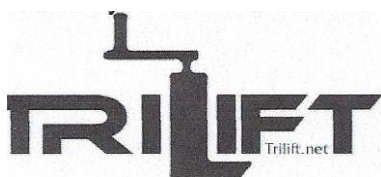
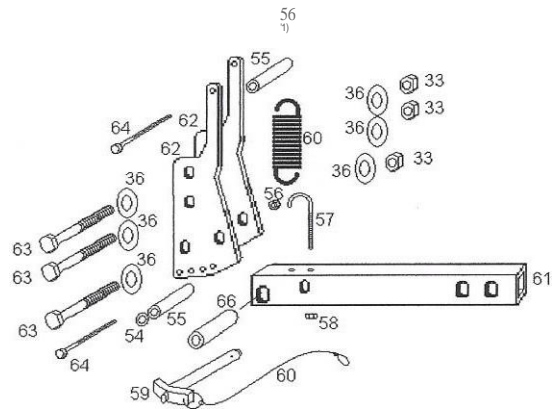

TRILIFT
1518 S. Santa Fe Ave.
Compton, CA 90221
1-800-30D-4192 (U.S.)

PAGE: 10 OF 12	DATE: 1 FEB 08	FORM#: 20803
REVISION LITTER: H	ECN#: 13644	APPROVED:

ACCESSORIES:



Licenses plate Holder with light.



Power head cover



Hitch pin lock

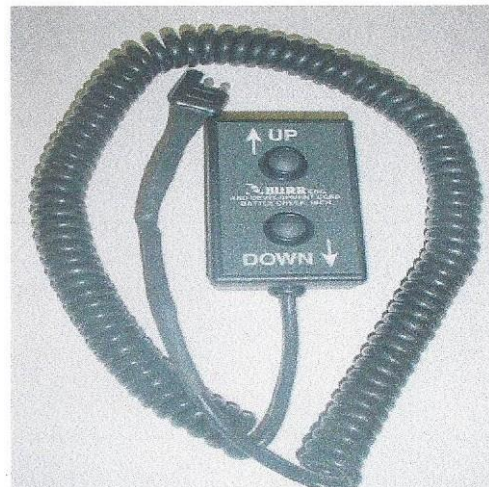

Remote Control



TRILIFT
1518 S. Santa Fe Ave.
Compton, CA 90221
1-800-300-4192 (U.S.)

PAGE: 11 OF 12	DATE: 1 FEB 08	FORM#: 20803
REVISION LETTER: H	ECN#: 13644	APPROVED:

AVAILABLE PARTS FOR THE TRILIFT



EXT04-3 4" Extended Bracket for Class-3 Hitch.



EXT07-3 7" Extended Bracket for Class-3 Hitch.



EXT04-2 4" Extended Bracket for Class-2 Hitch.



EXTLRO2-3 2" Lowering or Raising L bracket for Class-3 Hitch.



EXTLR04-3 4" Lowering or Raising L bracket for Class-3 Hitch.



EXTLRO6-3 6" Lowering or Raising L bracket for Class-3 Hitch.



EXTLR12-3 12" Lowering or Raising L bracket for Class-3 Hitch.

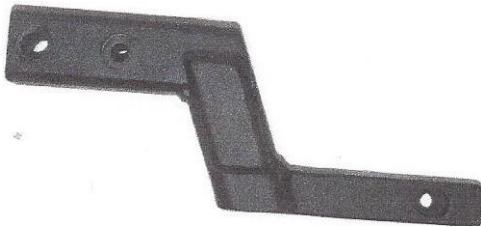

EXTLRO2-2 2" Lowering or Raising L bracket for Class-2 Hitch.



EXTLRO4-2 4" Lowering or Raising L bracket for Class-2 Hitch.



TRILIFT
 1518 S. Santa Fe Ave.
 Compton, CA 90221
 1-800-300-4192 (U.S.)

PAGE: 12 OF 12	DATE: 1 FEB08	IFOR; 803
REVISION: H	ECN#: 13644	APPROVED: